

Clovelly Court

West Drayton • London • UB7 9GU

PCM: £1,450 PCM



coopers
est 1986

A spacious one bedroom second floor apartment located in the ever popular Drayton Garden Village development. Close to Heathrow, West Drayton Station and Stockley Business Park. Comprising of double bedroom, very spacious lounge leading to open plan kitchen, patio, bathroom with shower over bath and storage cupboard. Benefits include entry phone system and undercroft parking space.

Sought after property

Well presented apartment

Entryphone system

Close to Stockley Business Park

Close to Heathrow Airport

Good transport links

Undercroft parking

Popular development

Close to local shops

Minutes away from West Drayton Station

Available Date

2nd August 2025

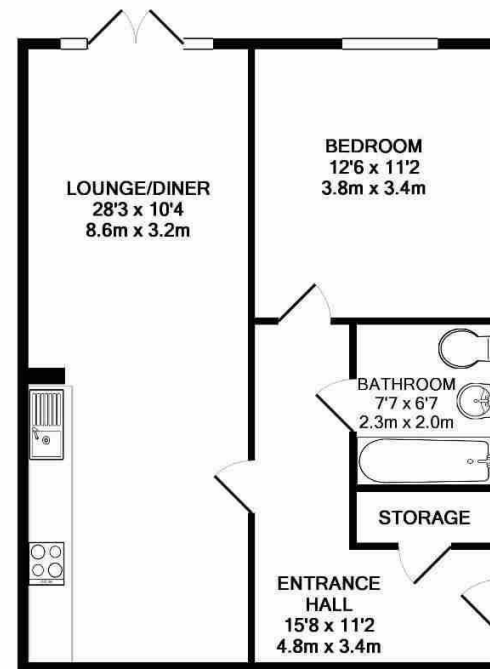

TOTAL APPROX. FLOOR AREA 606 SQ.FT. (56.3 SQ.M.)

Whilst every attempt has been made to ensure the accuracy of the floor plan contained here, measurements of doors, windows, rooms and any other items are approximate and no responsibility is taken for any error, omission, or mis-statement. This plan is for illustrative purposes only and should be used as such by any prospective purchaser. The services, systems and appliances shown have not been tested and no guarantee as to their operability or efficiency can be given.
Made with Metropix ©2015

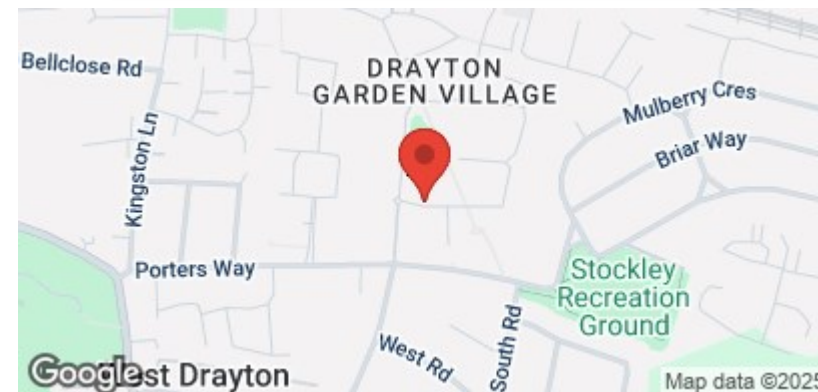

coopers
est 1986

01895 257 566

1 Vine Street, Uxbridge,
Middlesex, UB8 1QE

propertymanagement@coopersresidential.co.uk

CoopersResidential.co.uk

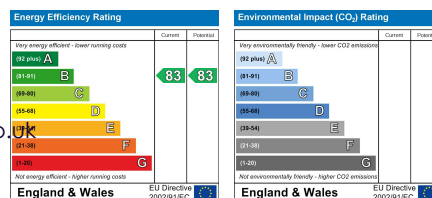

Important Notice: These particulars, whilst believed to be accurate are set out as a general outline only for guidance and do not constitute any part of an offer or contract. Intending purchasers should not rely on them as statements or representation of fact, but must satisfy themselves by inspection or otherwise has the authority to make or give any representation or warranty in respect of the property.